

NOTE: MALE AND FEMALE INTERLOCKS ARE 3 3/4" WIDE WITH A 1" THICKNESS

3'-8" (44")

FEMALE INTERLOCKS

SPACE FOR WATER TO FLOW "FREELY" TO DRAINAGE OUTLET

PIMPLE (Projections)/DIMPLE (Slots) DETAIL

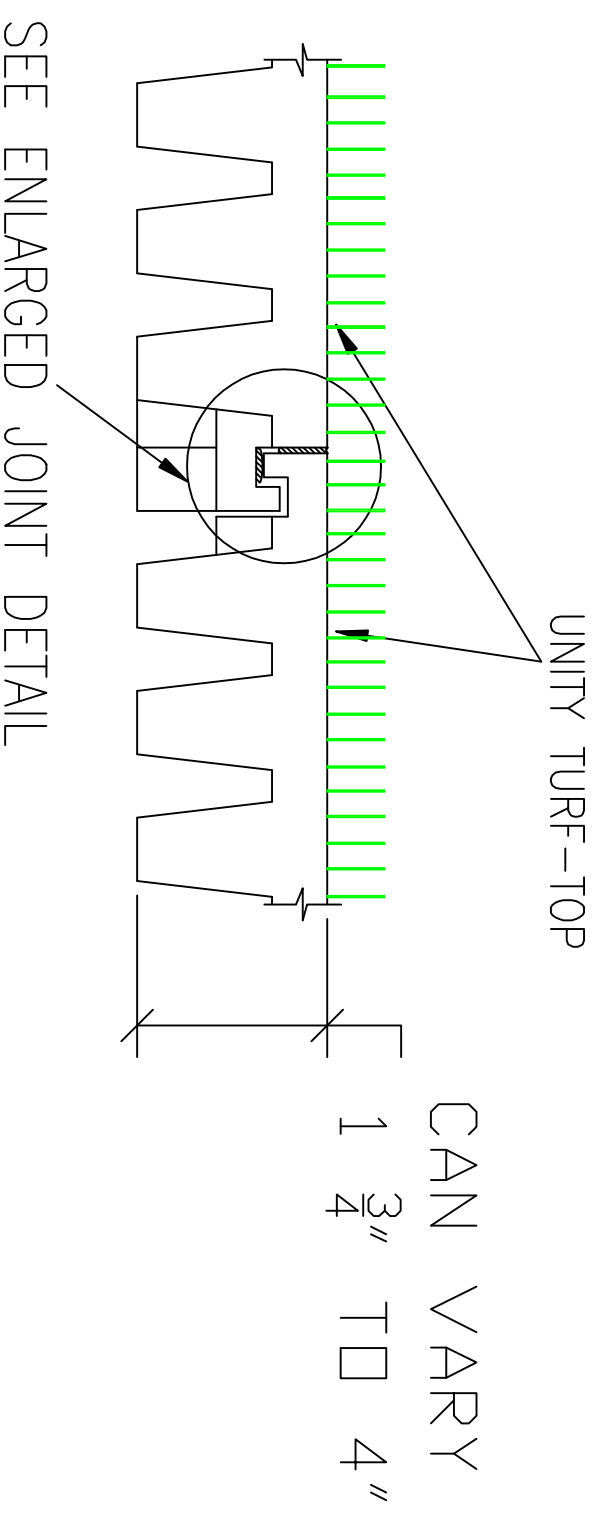
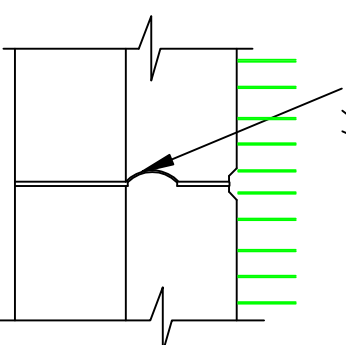

NOTE: FIELD APPLY ADHESIVE AT EACH INTERLOCK BOTH INSIDE THE JOINT AND ON TOP (OUTSIDE EDGE)

ENLARGED INTERLOCK JOINT DETAIL

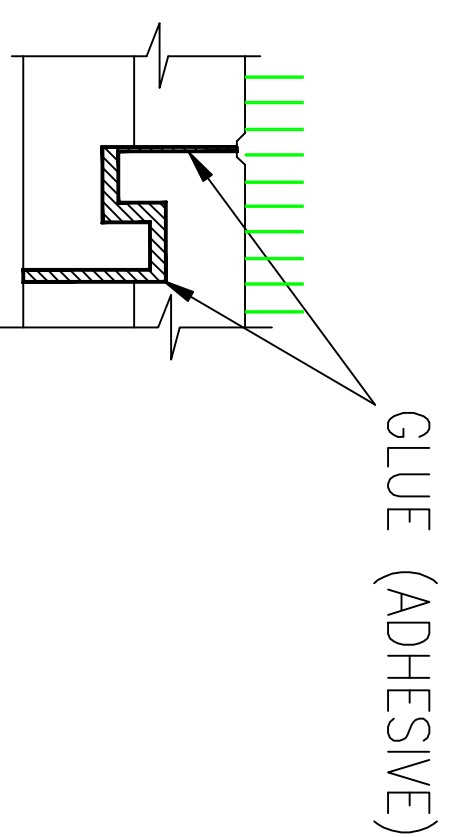

JOINT DETAIL AT PIMPLE (Projections)/DIMPLE (Slots)

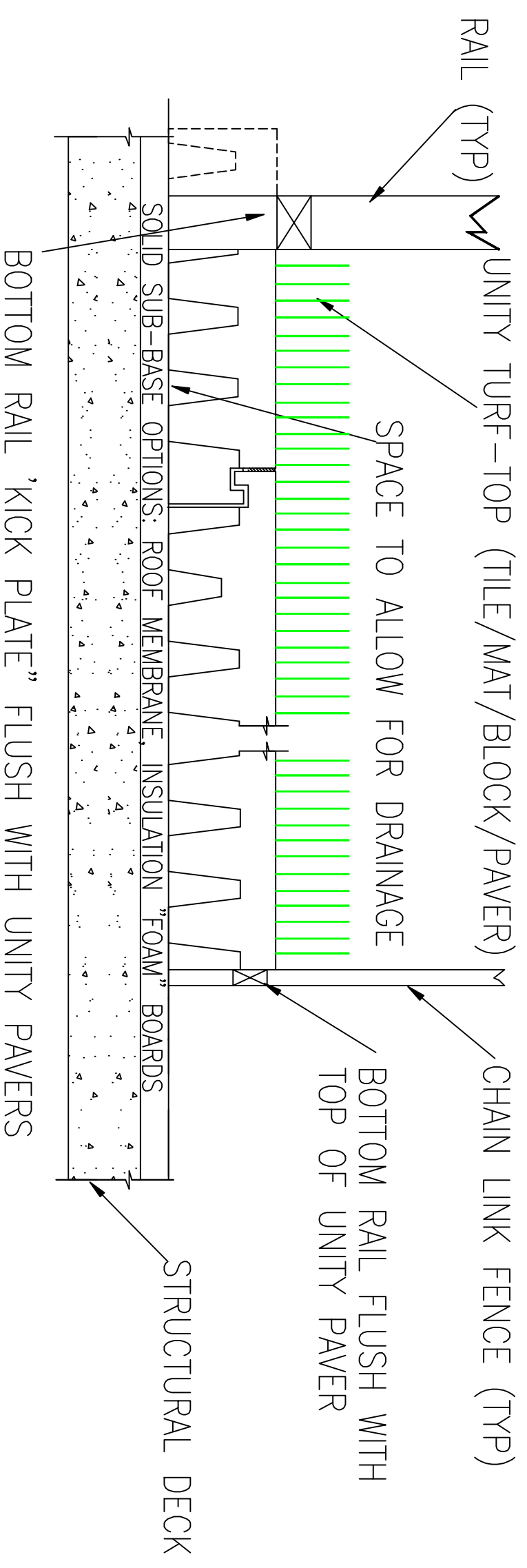

SIDE VIEW OF RAIL AND/OR FENCE DETAIL

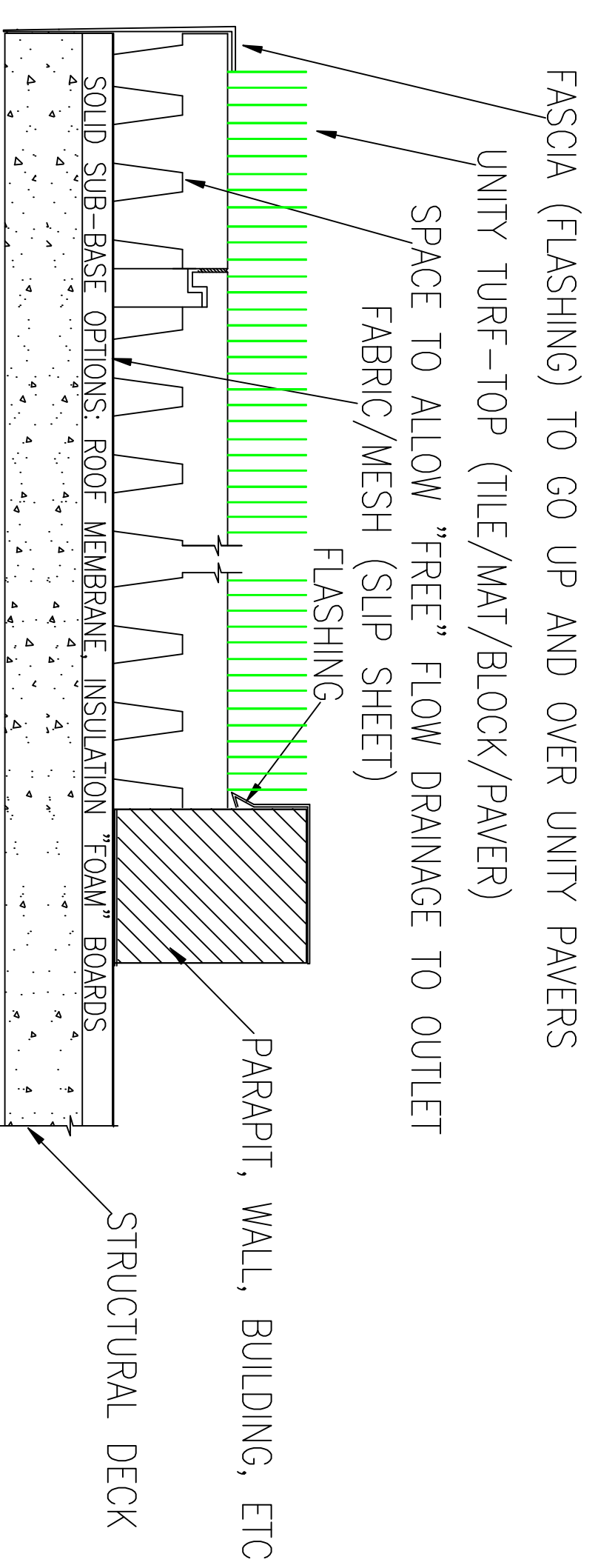

SIDE VIEW OF FASCIA AND/OR BOARDER DETAIL

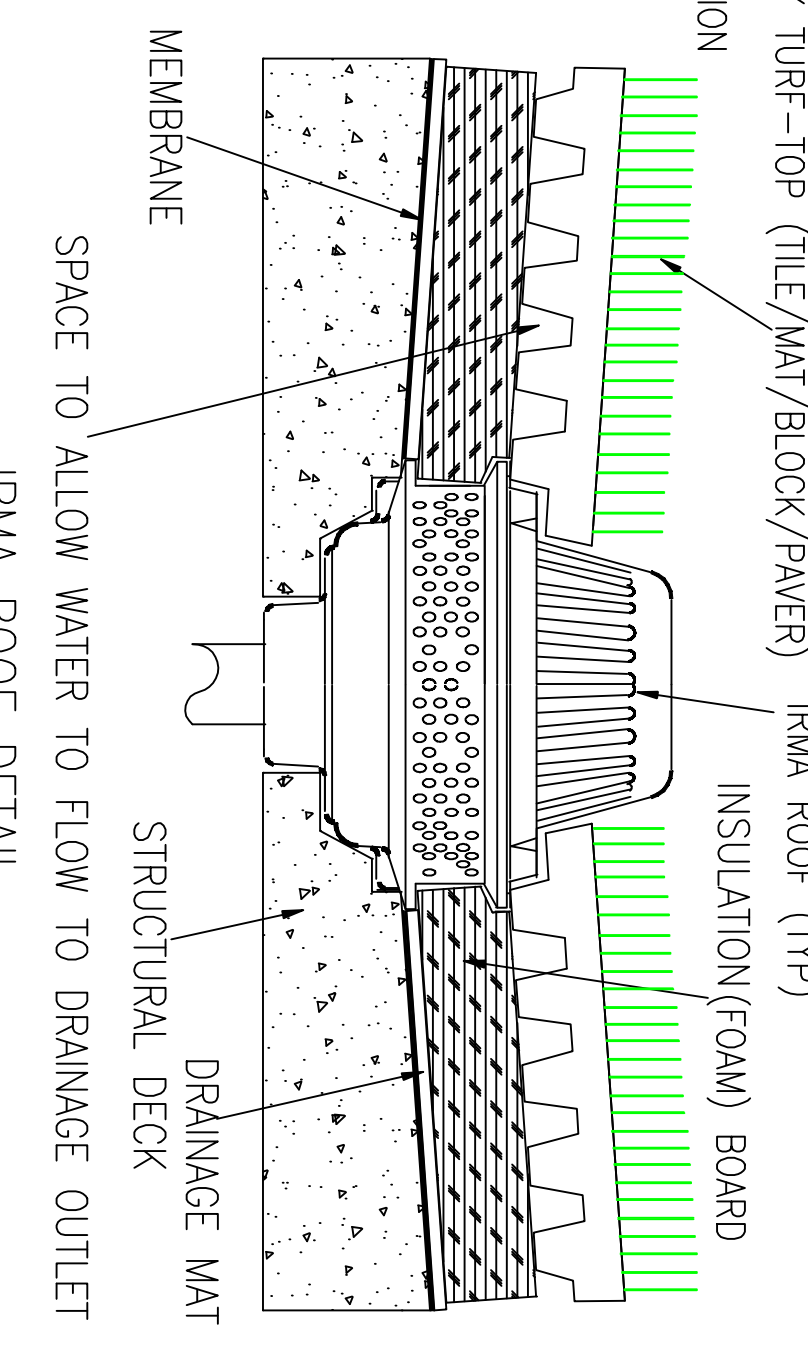
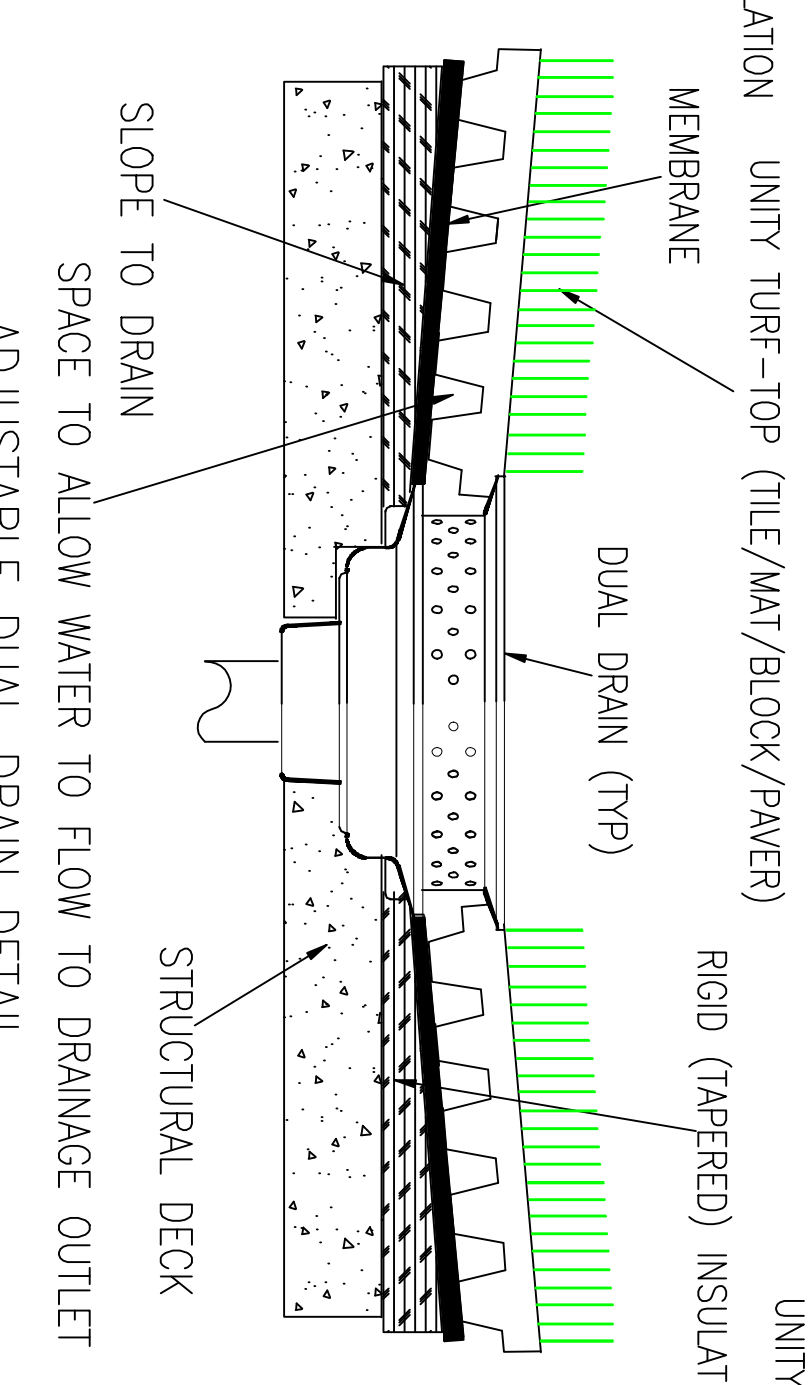
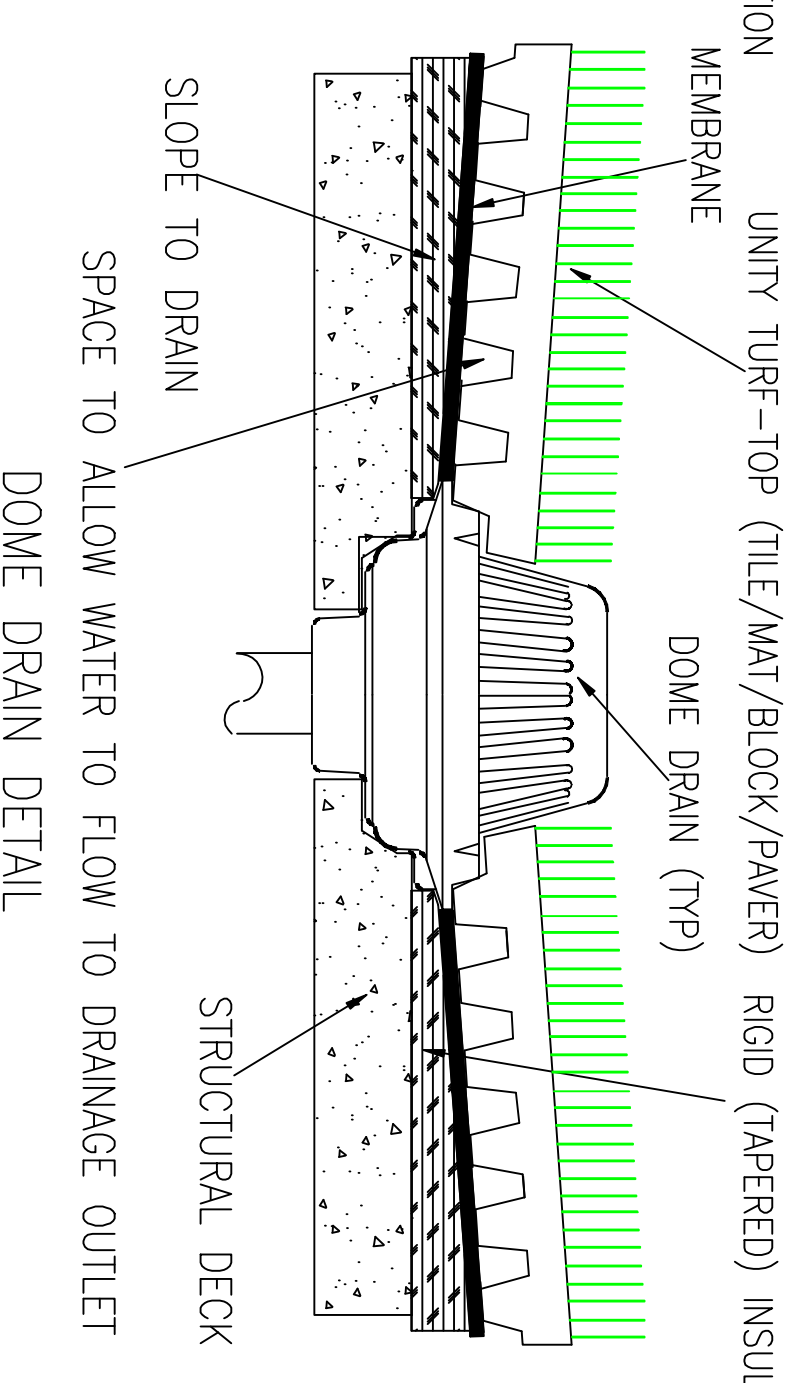
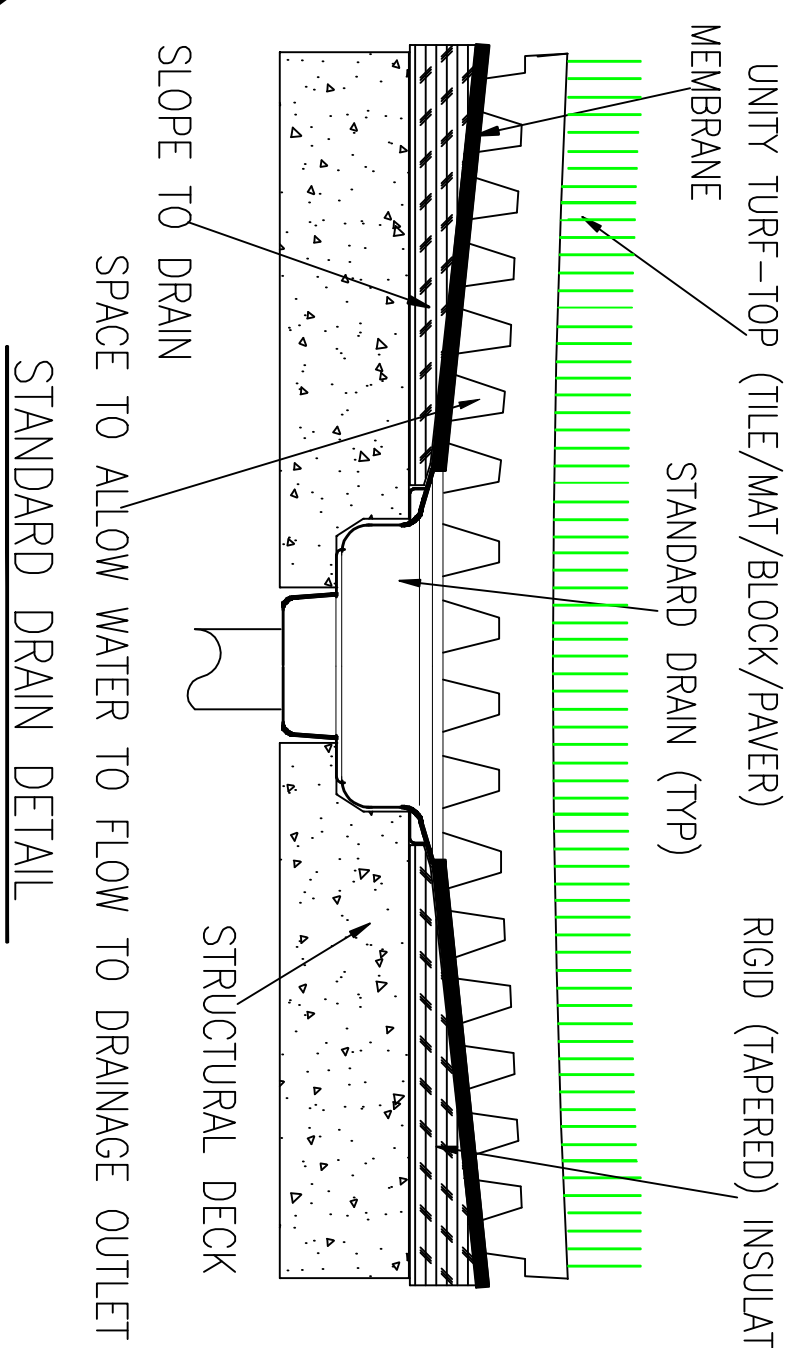

General Notes

**UNITY STANDARD TURF-TOP RUBBER PAVER PRODUCT DETAIL
SELF-INTERLOCKING WITH BUTTON LOCK TECHNOLOGY**

No.	Revision/Issue	Date
1	ORIGINAL	1/23/20

UNITY CREATIONS LTD./UNITY SURFACING SYSTEMS

SALES & MARKETING:
56 BLOOMINGDALE RD.
HICKSVILLE, NY 11801

T: (1-877) 41-UNITY
F: (845) 246-1700
E-MAIL: productinfo@surfacingystems.com
WEB: www.surfacingystems.com

MANUFACTURING PLANT:

UNITY CREATIONS, LTD.
3997 ROUTE 9W (P.O. BOX 9)
SAUGERTIES, NY 12477

PROJECT:

Project	Sheet
---------	-------

Date	
Scale	NOTED