

GROUND-LEVEL PLAYGROUND

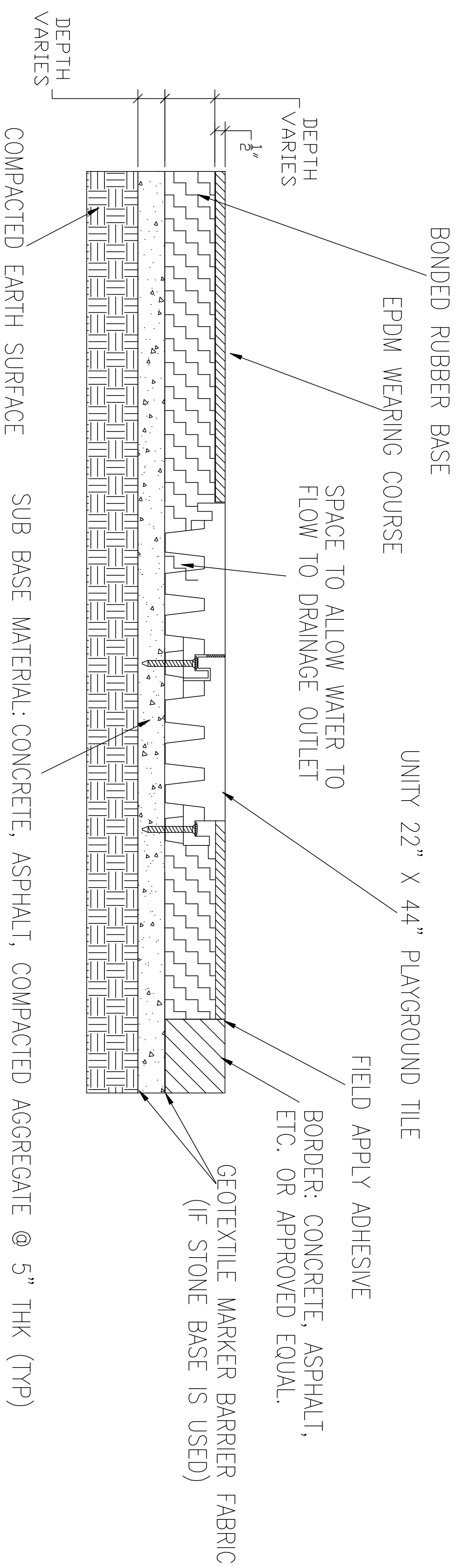

SUB-SURFACING/BASE OPTIONS - RECESSED SURFACE W/ BORDER

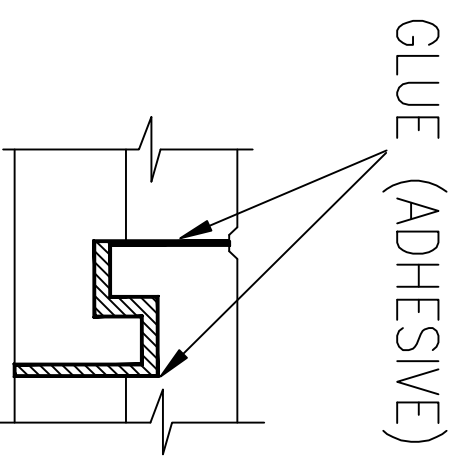

NOTE: FIELD APPLY ADHESIVE AT EACH INTERLOCK BOTH INSIDE THE JOINT AND ON TOP (OUTSIDE EDGE) ENLARGED JOINT INTERLOCK DETAIL

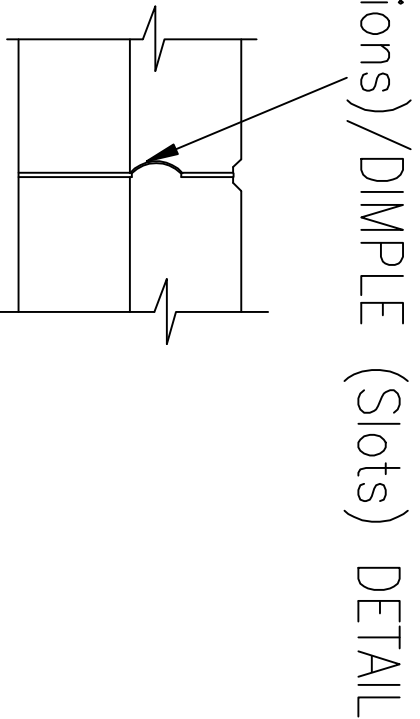

JOINT DETAIL AT PIMPLE (Projections)/DIMPLE (Slots)

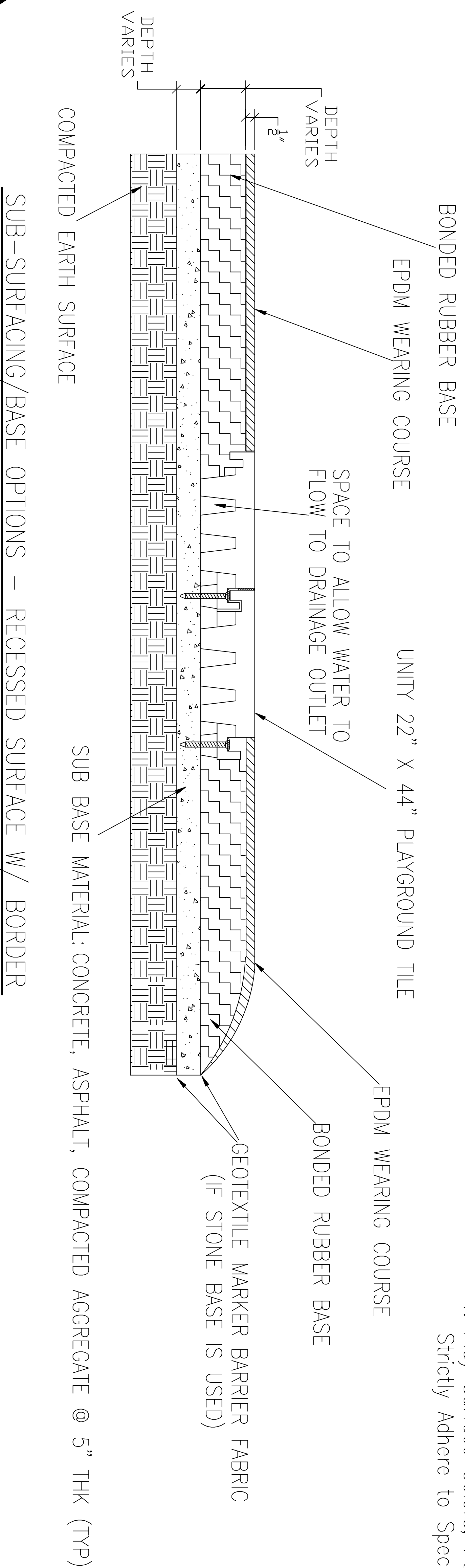

SUB-SURFACING/BASE OPTIONS - RECESSED SURFACE W/ BORDER

NOTES:

1. Playground Safety Surface Depth is Subject to Fall Height Ratings and Play Equipment Manufacturer Specified Recommendations
2. Sub Base Shall be Pitched to Match Slope Directions and Rates of the Finish Grade See Sheet for Finished Grades and Slopes
3. Certification Showing Compliance With ASTM 1292 Shall be Required Before Installation
4. Play Surface Colors, Patterns and Thickness Shall Strictly Adhere to Spec Sheets

UNITY PLAYGROUND TILE -TO- PIP DETAILS

No.	1	ORIGINAL	11/21/19
Revision/Issue			
Date			

UNITY CREATIONS LTD./UNITY SURFACING SYSTEMS

SALES & MARKETING:
 56 BLOOMINGDALE RD.
 HICKSVILLE, NY 11801
 T: (1-877) 41-UNITY
 F: (845) 246-1700
 E-MAIL: productinfo@surfacingystems.com
 WEB: www.surfacingystems.com

MANUFACTURING PLANT:

UNITY CREATIONS LTD.
 3997 ROUTE 9W (P.O. BOX 9)
 SAUGERTIES, NY 12477

PROJECT:

Project	Sheet
Date	
Scale	NOTED